

GUIDE TO ACTIVATING YOUR CHANGI TRAVEL ESIM



*This guide is created as a general basis & each step is dependent on the mobile device.

ANDROID

[Click for video guide](#)

STEP 1

Under 'Settings' > 'SIM Manager' > 'Add eSIM' > 'Scan QR code'

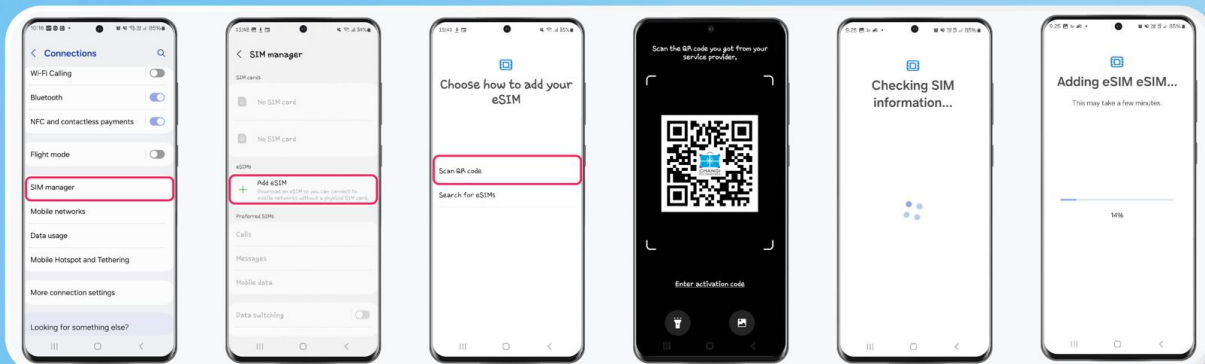

STEP 2

Turn off Local SIM card & turn on the newly activated Changi Travel eSIM

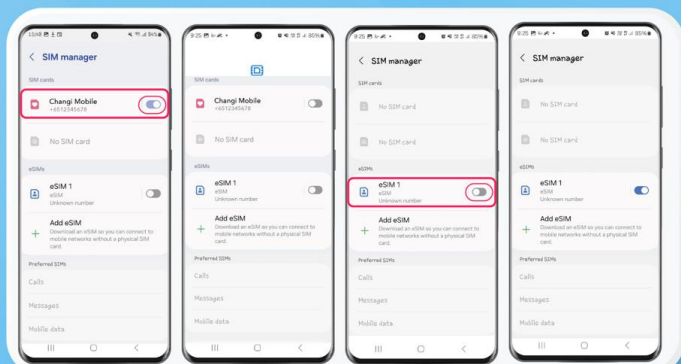

STEP 3

Under 'Connections' > 'Mobile Networks' > 'Turn on 'Data roaming'

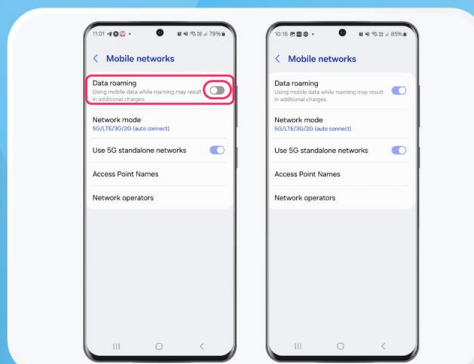

iOS

[Click for video guide](#)

STEP 1

Under 'Settings' > 'Mobile Service' > 'Add eSIM' > 'Use QR code'

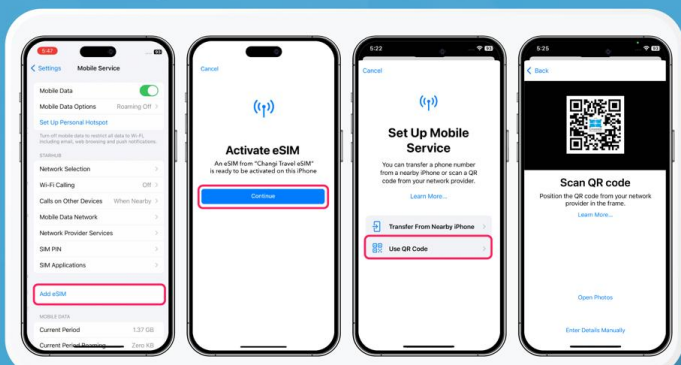

STEP 2

Turn off Local SIM card & turn on the newly activated Changi Travel eSIM

